

MALTA TOWNSHIP SECTION 17 R-12 TWP-10 MORGAN COUNTY, OH

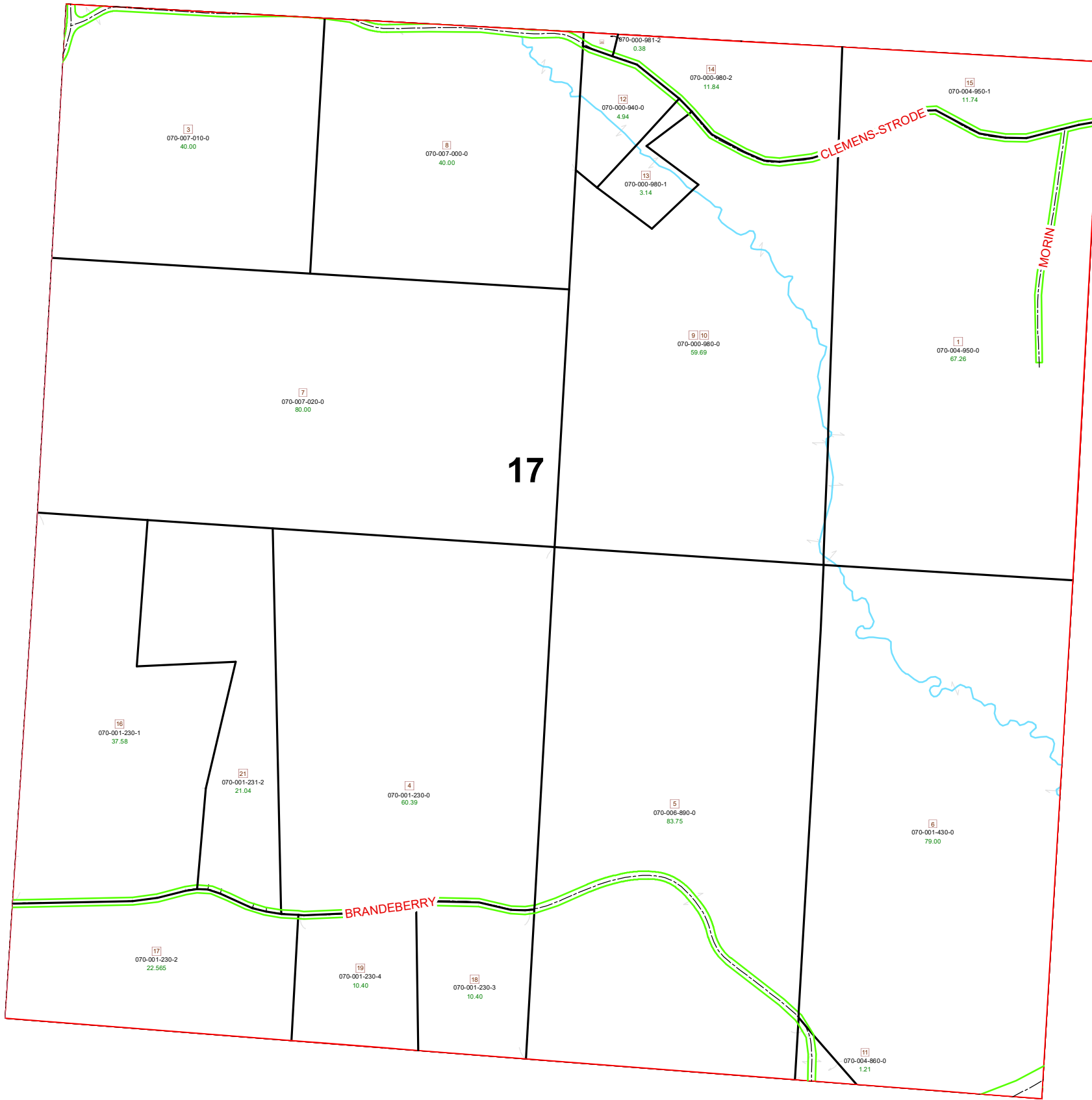

PIN	VOL	PAG	Owner	LegalDescr	Acres
070-001-230-1	OR203	1282	BOGUE VIKKI & TOREN	R12 T10 S17 SD 16 SU	37.58
070-001-430-0	OR210	2977	CAMPBELL CECIL L & TERRI L	R12 T10 S17 SD 6 SUR	79
070-000-940-0	OR203	2280	CLEMENS JAMES D TRUSTEE	R12 T10 S17 SD 12	4.94
070-000-980-1	OR202	1465	CLEMENS JOSEPH R & GOODNITE TERRI A	R12 T10 S17 SD 13	3.146
070-000-980-0	OR222	1416	CLEMENS JOSEPH R & TERRI A	R12 T10 S17 SD 9-10	59.693
070-000-980-2	OR175	800	CLEMENS JOSEPH R & TERRI A	R12 T10 S17 SD 14 SU	11.841
070-000-981-2	OR215	1926	DAVIS JOHN D & REBECCA J	R12 T10 S17 SD 20 SU	0.38
070-004-860-0	D.V 188	678	MASSEY WILLIAM M & JANICE K	R12 T10 S17 SD 11	1.212
070-001-230-0	OR234	2441	RILEY JESSICA SUE	R12 T10 S17 SD 4	60.39
070-001-230-2	OR231	4284	SIX AMANDA L	R12 T10 S17 SD 17	22.565
070-001-231-2	OR226	3315	SIX DANIEL L	R12 T10 S17 SD 21	21.045
070-001-230-4	OR213	154	SIX JESSICA SUE	R12 T10 S17 SD 19	10.4
070-001-230-3	OR213	988	SIX JESSICA SUE	R12 T10 S17 SD 18	10.4
070-006-890-0	D.V 163	353	SOUTHALL DONALD R & CHARLOTTE	R12 T10 S17 SD 5	83.75
070-007-020-0	OR232	2117	STRODE DWIGHT	R12 T10 S17 SD 7	80
070-007-000-0	OR232	2117	STRODE DWIGHT	R12 T10 S17 SD 8	40
070-007-010-0	OR232	2117	STRODE DWIGHT	R12 T10 S17 SD 3	40
070-004-950-0	D.V 201	761	WELCH ROY L & LINDA A	R12 T10 S17 SD 1-2 S	67.26
070-004-950-1	OR143	427	YOUNG JOHN MICHAEL & JENNIFER MARIE	R12 T10 S17 SD 15 SU	11.74

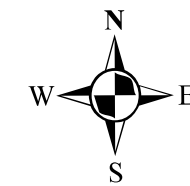

Boundaries	
----- Hidden	--- ROW
--- Hydro	--- Section
--- Roads	--- Lot
--- County	--- Township
--- Parcel	□ Parcels



Disclaimer: The information that these maps contains is for reference purposes only. Please bring any erros to the attention of the Engineer's Office staff.

Thank you